

## 23.Rear Quarter Trim

### A: REMOVAL

#### 1. 4 DOOR MODEL

##### CAUTION:

- Airbag system satellite safing sensor is located in the lower of the rear seat cushion center. Before removing the rear seat, refer to “CAUTION” of “General Description” in “AIRBAG SYSTEM” section. <Ref. to AB-10, CAUTION, General Description.>
- The airbag system is fitted with a backup power supply. After disconnecting the battery ground cable, the airbag may operate if you do not wait for 60 seconds before starting the service of airbag system.

- 1) Disconnect the ground cable from battery and wait for at least 60 seconds before starting work.
- 2) Remove the clips, and remove the trim panel - rear pillar UPR.

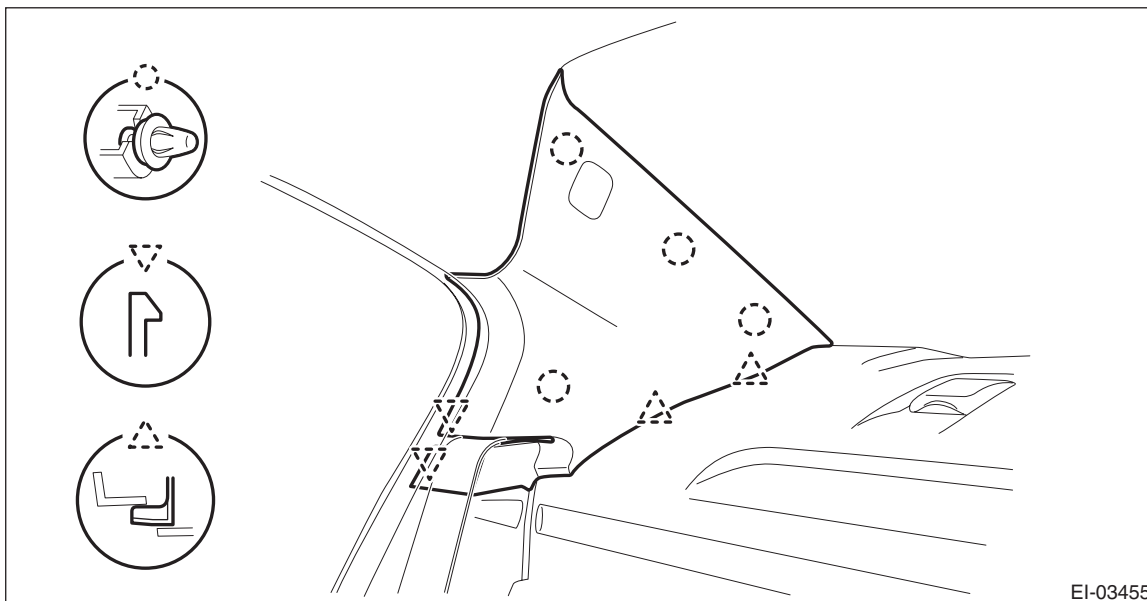

## 3) Remove the rear seat cushion assembly.

(1) Push the corners of the rear seat cushion from above.

(2) While pushing the corners of the rear seat cushion from above, pull the knob of the hook - seat cushion rear towards yourself.

(3) While pulling the knob towards yourself, disconnect the hooks by lifting up the rear seat cushion.

### NOTE:

Pull the left side of the knob to disconnect the LH side hook, and pull the right side of the knob to disconnect the RH side hook.

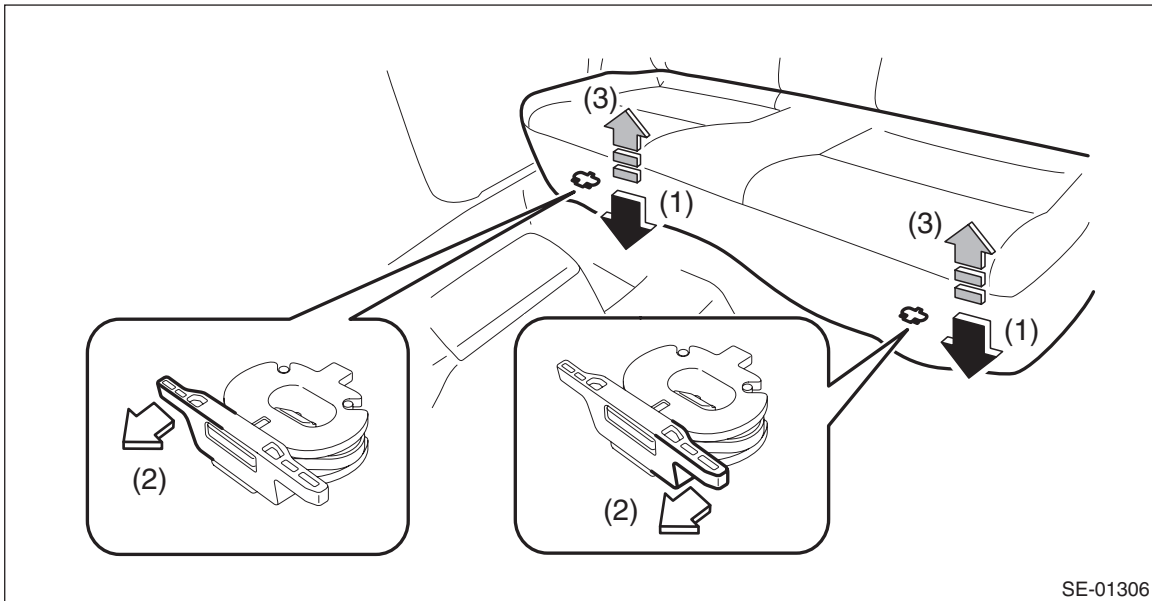

SE-01306

(4) Remove the hook (A) by pushing it back while lifting the front side of the rear seat cushion, and remove the rear seat cushion.

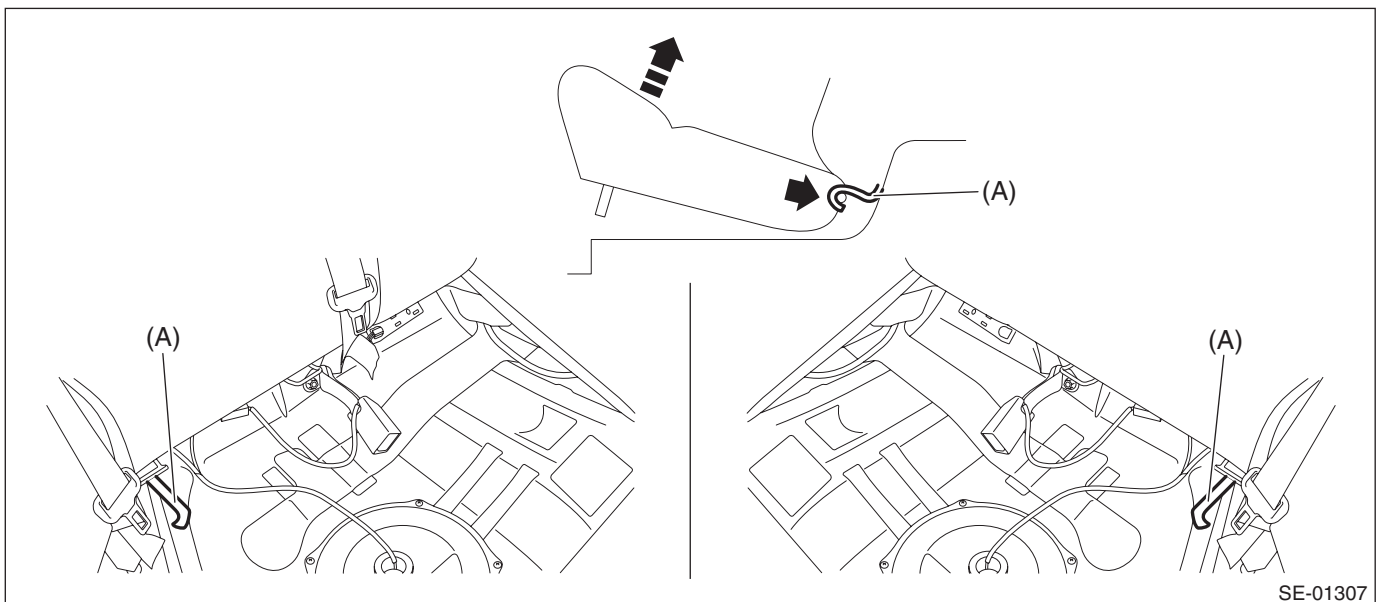

SE-01307

## Rear Quarter Trim

### EXTERIOR/INTERIOR TRIM

4) Release the clips and claws, and then remove the cover side sill - rear INN.

#### CAUTION:

Do not pull with excessive force. Doing so may damage the claws of the cover side sill - rear INN.

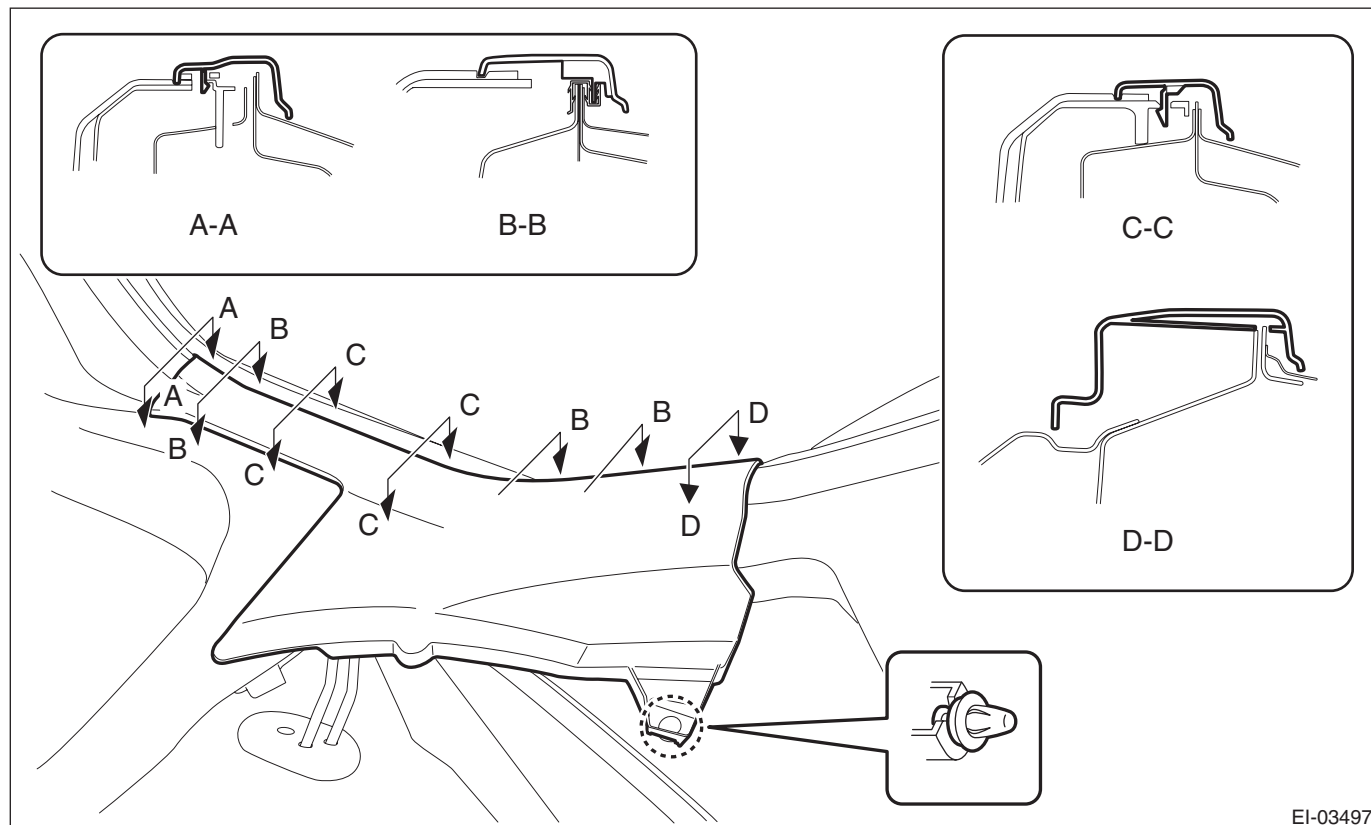

EI-03497

5) Remove the trim panel - rear pillar LWR.

- (1) Remove the clips, and turn over the trim panel - trunk side.
- (2) Remove the clips, and remove the trim panel - rear pillar LWR.

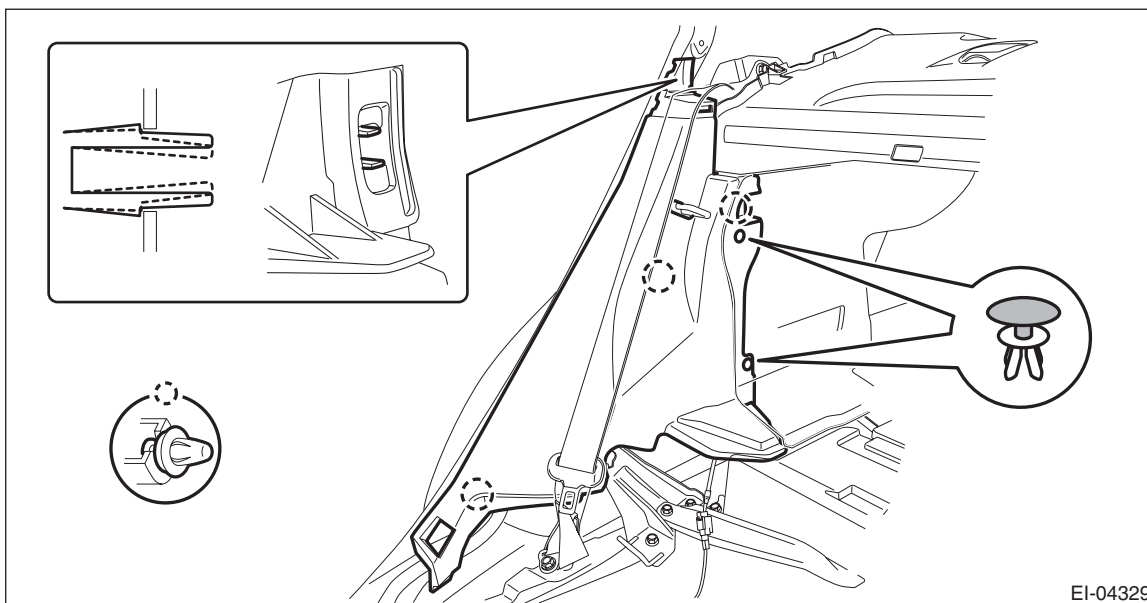

EI-04329

## 2. 5 DOOR MODEL/XV MODEL

### CAUTION:

- Airbag system satellite safing sensor is located in the lower of the rear seat cushion center. Before removing the rear seat, refer to “CAUTION” of “General Description” in “AIRBAG SYSTEM” section. <Ref. to AB-10, CAUTION, General Description.>

- The airbag system is fitted with a backup power supply. After disconnecting the battery ground cable, the airbag may operate if you do not wait for 60 seconds before starting the service of airbag system.

1) Disconnect the ground cable from battery and wait for at least 60 seconds before starting work. <Ref. to NT-5, BATTERY, NOTE, Note.>

### NOTE:

For the 12 volt engine restart battery of HEV model, disconnect the ground terminal from 12V engine restart battery sensor.

2) Remove the screws and clips, and remove the trim panel - rear quarter pillar UPR.

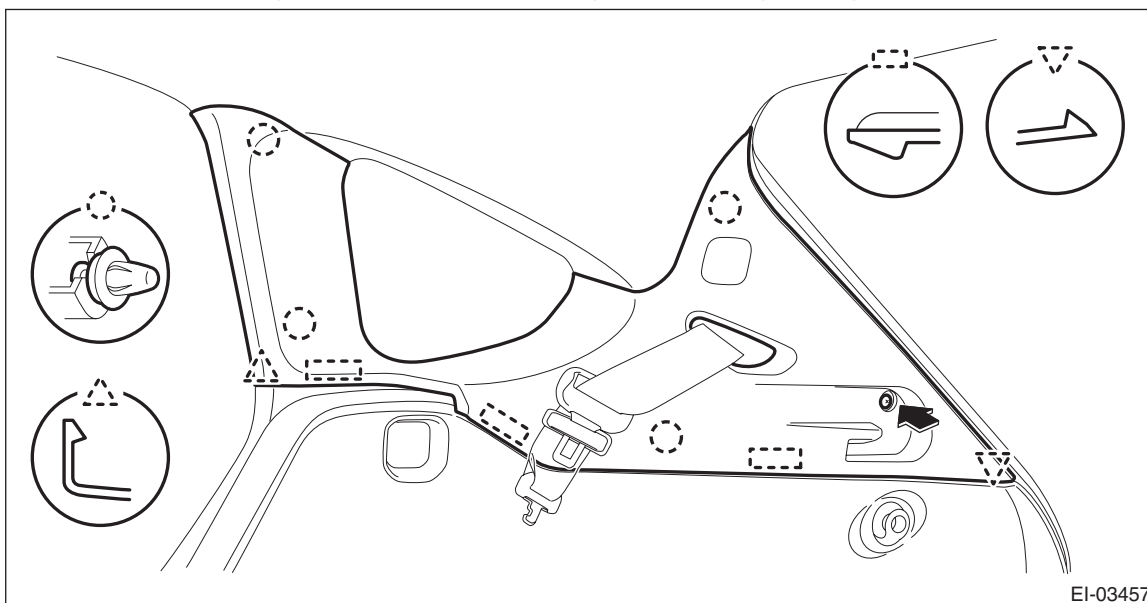

EI-03457

## Rear Quarter Trim

### EXTERIOR/INTERIOR TRIM

#### 3) Remove the rear seat cushion assembly.

(1) Push the corners of the rear seat cushion from above.

(2) While pushing the corners of the rear seat cushion from above, pull the knob of the hook - seat cushion rear towards yourself.

(3) While pulling the knob towards yourself, disconnect the hooks by lifting up the rear seat cushion.

#### NOTE:

Pull the left side of the knob to disconnect the LH side hook, and pull the right side of the knob to disconnect the RH side hook.

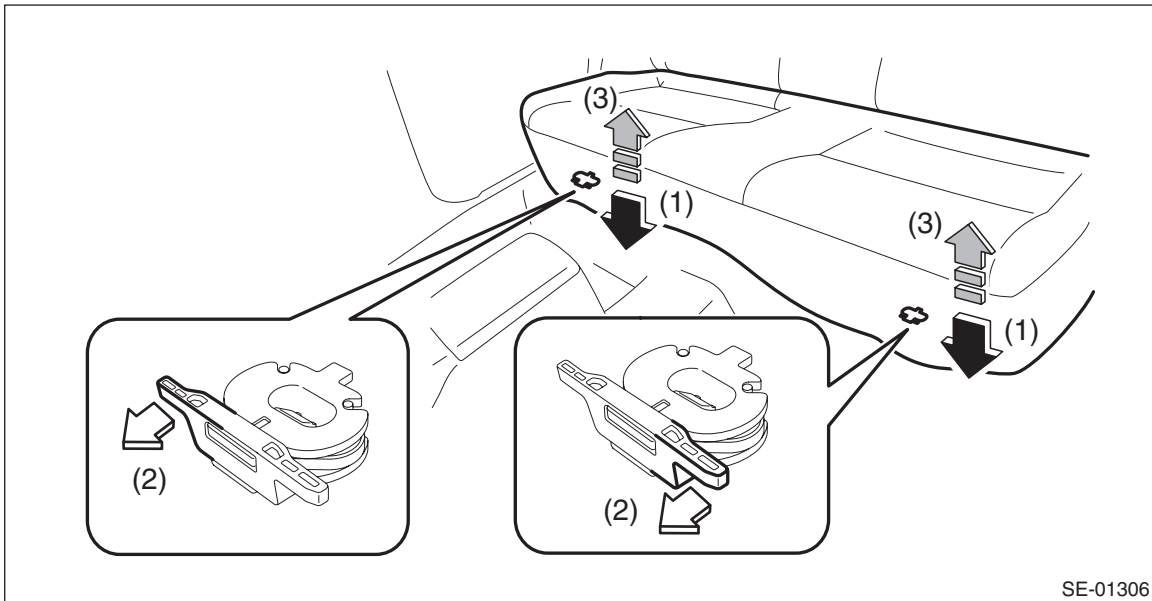

(4) Remove the hook (A) by pushing it back while lifting the front side of the rear seat cushion, and remove the rear seat cushion.

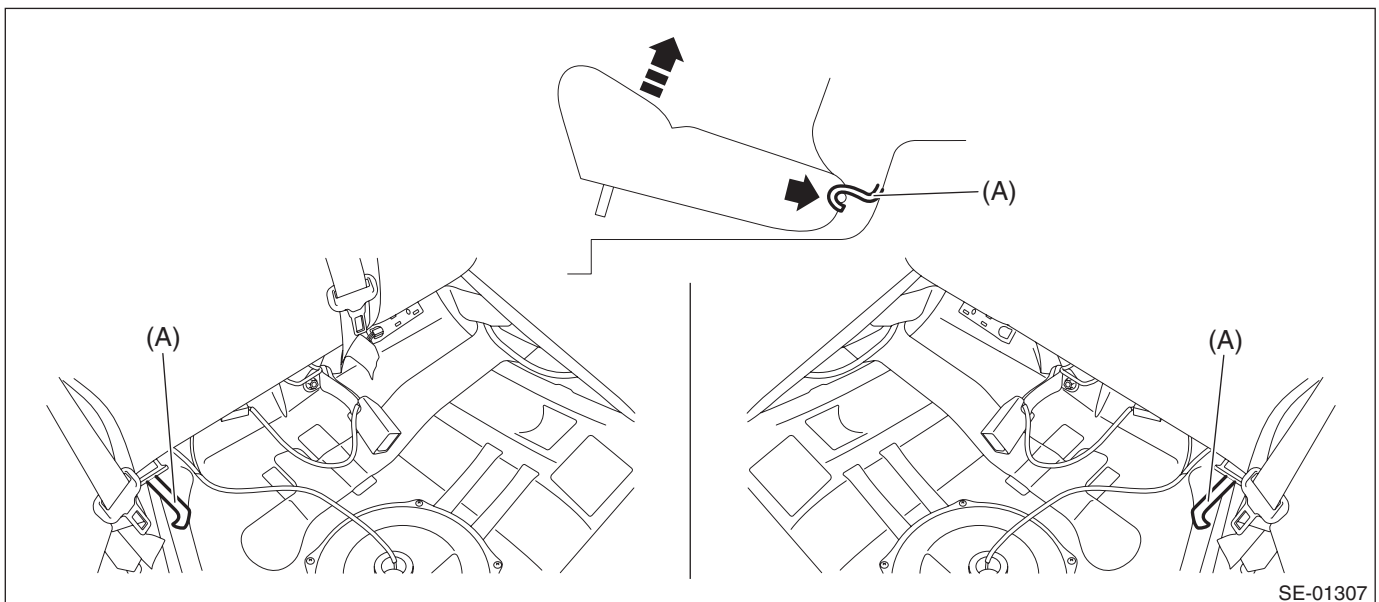

4) Release the clips and claws, and then remove the cover side sill - rear INN.

**CAUTION:**

**Do not pull with excessive force. Doing so may damage the claws of the cover side sill - rear INN.**

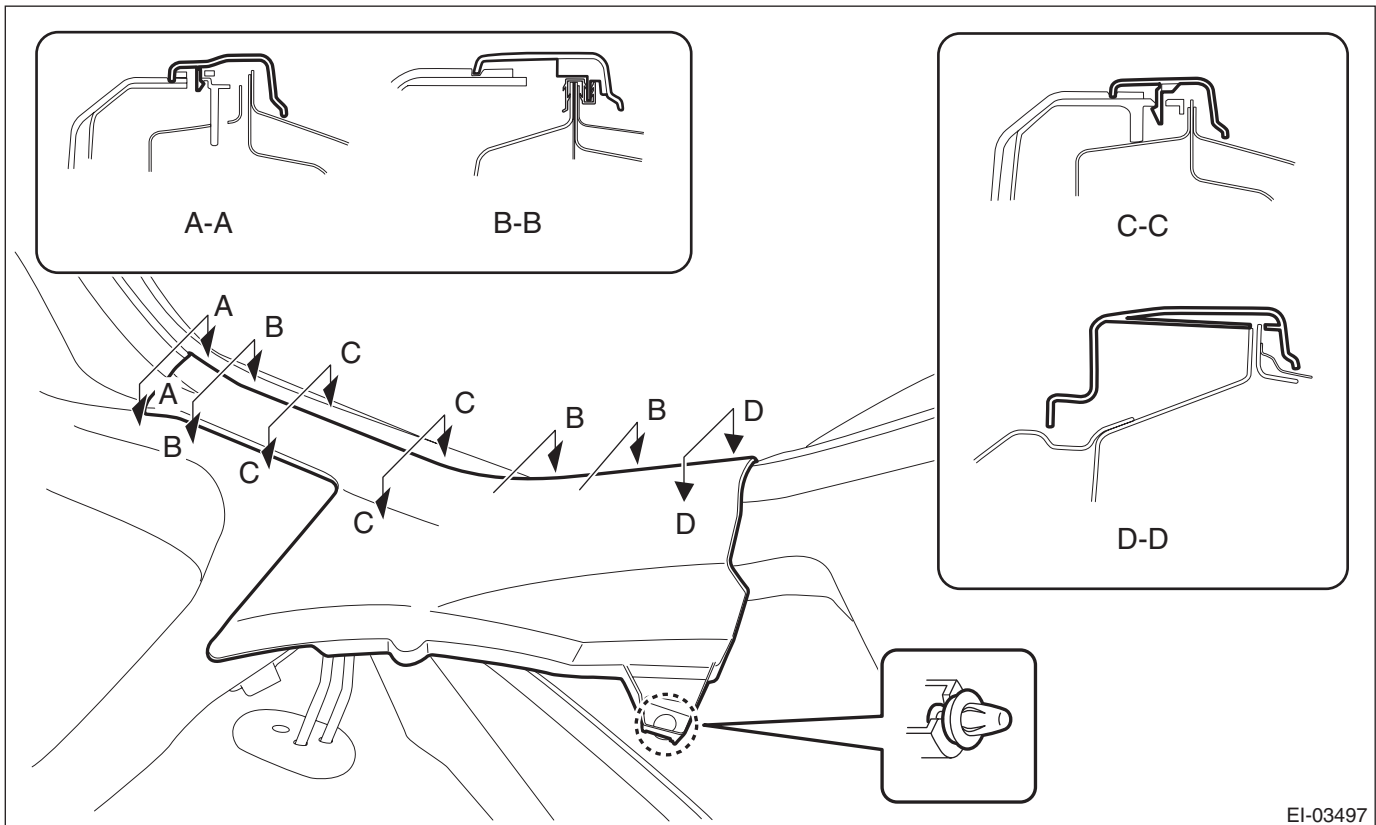

EI-03497

5) Remove the mat - rear floor CTR and the spacer - rear floor side.

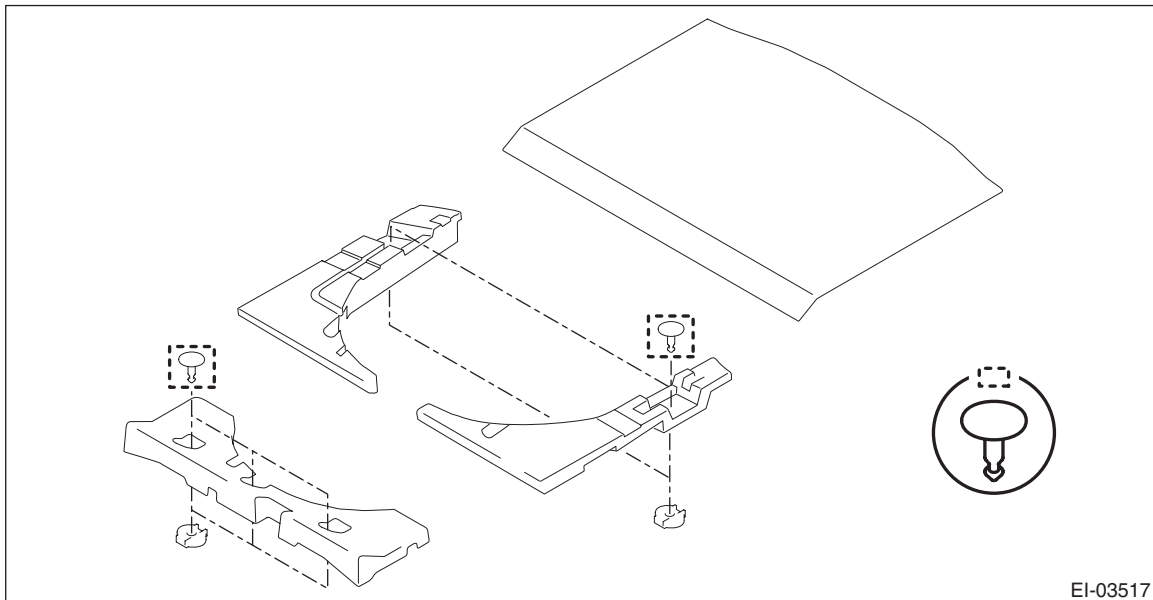

EI-03517

## Rear Quarter Trim

### EXTERIOR/INTERIOR TRIM

6) Remove the sub-trunk box and side spacers. (HEV model)

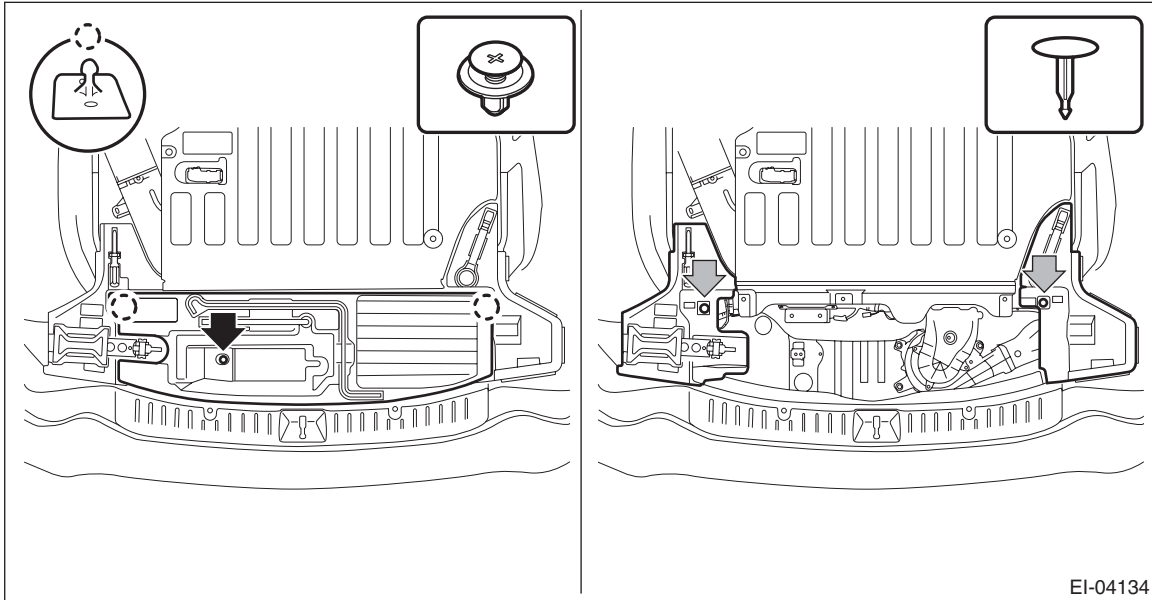

(1) Release the clips and side spacers, then detach the sub-trunk box.

(2) Remove the clips and detach the side spacers.

7) Remove the clips, and remove the trim panel - rear skirt.

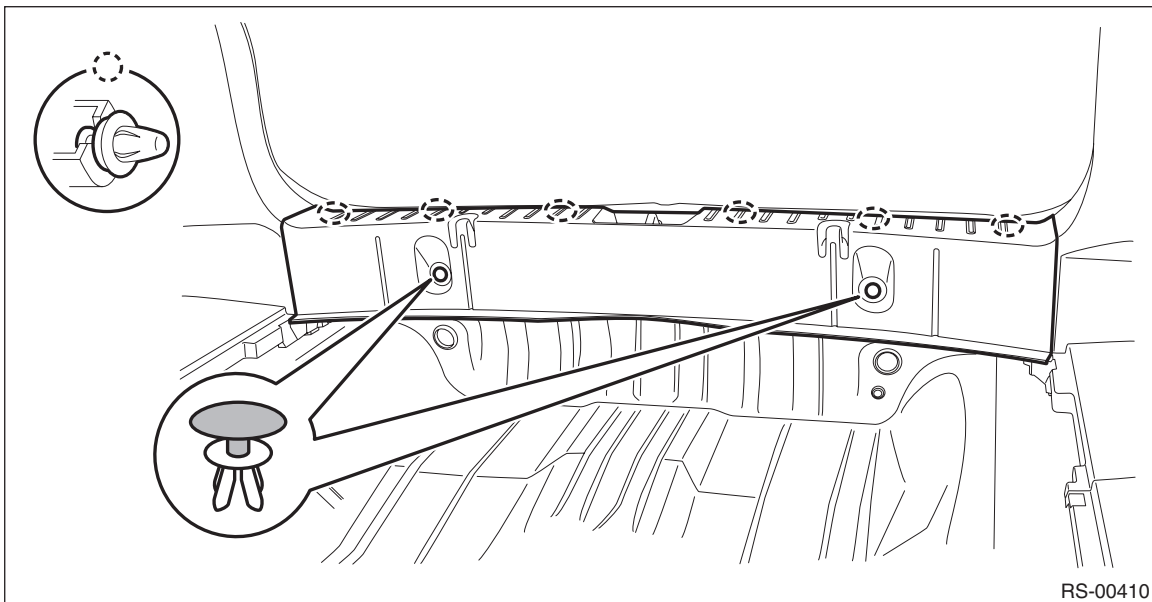

- 8) Remove the trim panel - rear apron.
  - (1) Remove the caps, and remove the bolts.
  - (2) Remove the screws.
  - (3) Disengage the clips, and remove the trim panel - rear apron.

**NOTE:**

For LH side, disconnect the connector of the luggage room light.

- Gasoline engine model

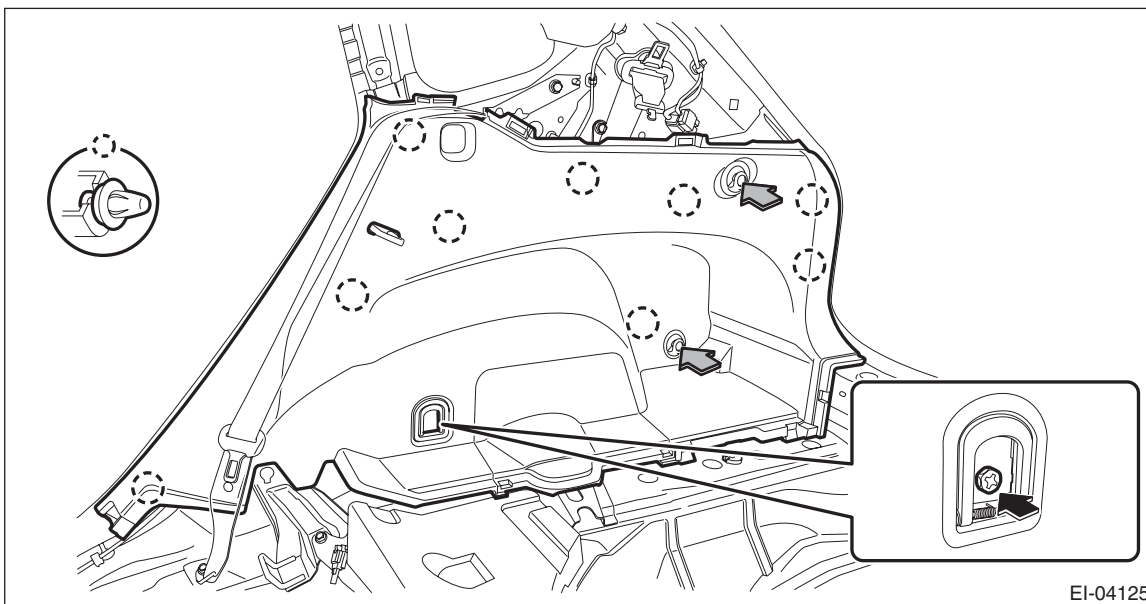

- HEV model

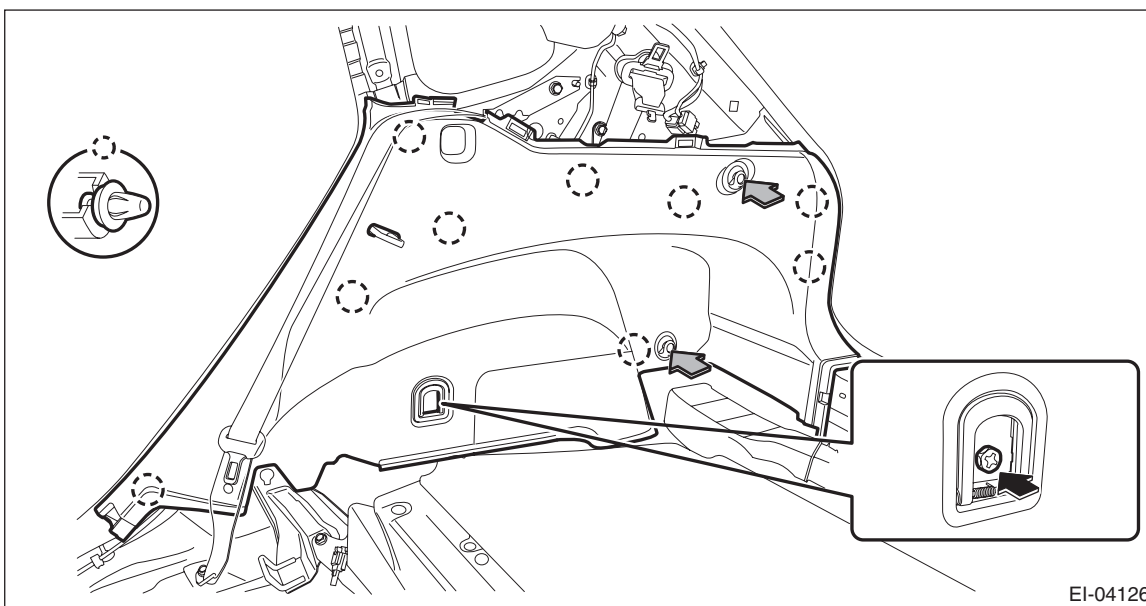

## B: INSTALLATION

Install each part in the reverse order of removal.

**Tightening torque:**

**Rear seat backrest assembly:** <Ref. to SE-5, REAR SEAT, COMPONENT, General Description.>